



# BRAKLUBE PLUS PRO

CRC Braklube Plus Pro combines the high quality of CRC Braklube Pro with an innovative dispensing system, that allows you to easily apply this premium brake grease without waste or mess. CRC Braklube Plus Pro is ideal for the lubrication of moving parts on calipers and drum brake systems when assembling, installing or rebuilding.



## PREMIUM BRAKE GREASE:

- Well balanced viscosity: does not run or drip off, even at high temperature
- Extends the life of your brake pads and calipers
- Prevents brakes from squeaking
- Excellent water and heat resistance (up to + 240°C)
- Prevents corrosion
- Compatible with all materials in the brake area
- Metal and particle free (compatible with ABS and aluminum brake calipers)
- Brush delivered with every can: ideal for easy application on bigger surfaces

## THE MOST ADVANCED SYSTEM FOR DISPENSING BRAKLUBE PRO

- **Inventive output regulator:** choose the desired output for economical usage
- **Application brush (included):** use with brush for bigger surfaces, use without brush for detailed application
- **360° usability:** easy to reach difficult areas
- **Protection cap**
- **Innovative dispensing system:** no residue is left in the can

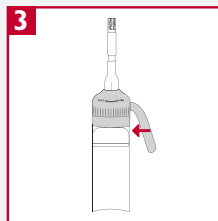
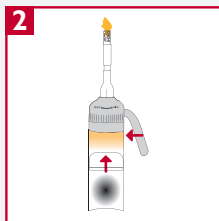
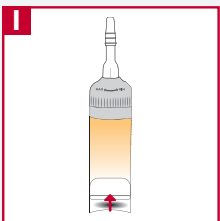

# WE DID THE TEST: CRC Braklube Pro offers the best viscosity!

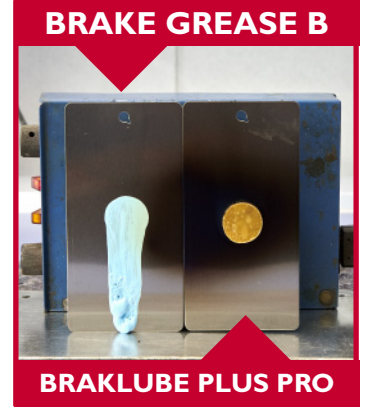

**TEST:** Braklube Plus Pro and two other brake greases were smeared on a metal plate that was placed vertically and heated up to + 240°C, simulating the working of brakes.

**RESULT:** CRC Braklube Plus Pro does not run or drip off. Compared to its branded competitors, CRC Braklube Plus Pro resists the high temperatures much better, offering longlasting lubrication and protection for maximum brake efficiency and minimum wear.



## THE COMPLETE BRAKLUBE PRO RANGE



### CRC BRAKLUBE PRO AEROSOL 250ML

Braklube Pro in a practical spray can that distributes the grease in an even, thin layer. Ideal for big brake pads.

Ref.	SIZE
32719	Aerosol 250 ml



### CRC BRAKLUBE PLUS PRO DISPENSER 200ML

Ready-to-use brake grease in an innovative dispensing system. Can be used with brush for bigger surfaces and without brush for detailed application. Adaptable output for economical usage.

Ref.	SIZE
32714	Dispenser 200 ml



### CRC BRAKLUBE PRO TUBE 100ML

Ready-to-use brake grease in a small and practical tube. Ideal for small brake parts. Smear the grease directly from the tube onto the desired brake part.

Ref.	SIZE
32815	Tube 100 ml

### TECHNICAL SPECIFICATIONS:

NLGI Grade :	2
Drop point (ASTM D 2265) :	Not dropping
Worked penetration (ASTM D 217) :	275 to 290 1/10 mm
SKF Emcor Test IP 220/85 :	Corrosion grade 0/0
Type of base oil :	Semi-synthetic
Viscosity of base oil at 40°C (ASTM D 445):	approx. 375 mm <sup>2</sup> /s
Viscosity of base oil at 100°C (ASTM D 445) :	approx. 32 mm <sup>2</sup> /s
4 ball test, welding load (DIN 51 350-04) :	2200 N
Density at 25° C (DIN 51 757) :	0,9 g/ml